

## Pictogram Installation

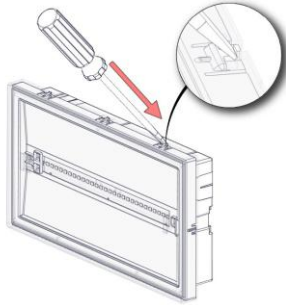

1



2

1. Install the pictogram in the diffuser, be careful to secure it on the 3 plastic holders.

2. Refit the diffuser with the pictogram to the luminaire.

## Technical Characteristics

BS-527/WP/V2	
OPERATION VOLTAGE	12-24V DC
MAXIMUM POWER CONSUMPTION	45mA at 12V DC / 55mA at 24V DC
LIGHT SOURCE	White LEDs
SOUND OUTPUT	Internal buzzer 80dB
DEGREES OF COVER PROTECTION	IP65
PRODUCED IN ACCORDANCE WITH	EN 60598-1, EN 60598-2-1, EN 61547, EN 55015
OPERATION TEMPERATURE RANGE	5 to 40 °C
RELATIVE HUMIDITY	Up to 95%
CONSTRUCTION MATERIAL	ABS/PC, PC
EXTERNAL DIMENSION (L x W x H)	240 x 90 x 44 mm
WEIGHT	465gr.
GUARANTEE	3 years

## LED Characteristics

BS-527/WP/V2	
MANUFACTURER	Olympia Electronics S.A.
MODEL NUMBER	1002205
VOLTAGE RANGE	8V DC
NOMINAL POWER	392mW
CONNECTIONS	Non reversible connection between main pcb and led module
TEMPERATURE (tc)	45 °C max. across the board

## Warranty

Olympia Electronics guarantees the quality, condition and operation of the goods. The period of warranty is specified in the official catalogue of Olympia Electronics and also in the technical leaflet, which accompanies each product. This warranty ceases to exist if the buyer does not follow the technical instructions included in official documents given by Olympia Electronics or if the buyer modifies the goods provided or has any repairs or re-setting done by a third party, unless Olympia Electronics has fully agreed to them in writing. Products that have been damaged can be returned to the premises of our company for repair or replacement, as long as the warranty period is valid. Olympia Electronics reserves the right to repair or to replace the returned goods and to or not charge the buyer depending on the reason of defection. Olympia Electronics reserves the right to charge or not the buyer the transportation cost.



72nd km. O.N.R. Thessaloniki-Katerini  
P.C. 60300 P.O. Box 06 Eginio Pierias Greece

[www.olympia-electronics.gr](http://www.olympia-electronics.gr)  
[info@olympia-electronics.gr](mailto:info@olympia-electronics.gr)



# BS-527/WP/V2

## WATERPROOF SLAVE INDICATION LUMINAIRE FOR FIRE DETECTION SYSTEM



Thank you for your trust in our products  
Olympia Electronics - European manufacturer

## Package Contents

1	Luminaire
1	Pictogram
1	Mounting accessories
1	Manual

## General

The BS-527/WP/V2 is one of the indication means of the fire detection panel. In case of activation, it produces a sound signal with the use of the internal buzzer and an optical signal by lighting (blinking) the led strip on the front side. So with these actions the public notice the sort of the danger. It cooperates with the following fire detection panels (BS-116, BS-632, BS-633, BS-634 and BS-636).

### ATTENTION!!!

1. Operations for installation, maintenance or testing must be done by authorized personnel only.



The light source contained in this luminaire shall only be replaced by the manufacturer, or his agent, or a similar qualified person.

NOTE! The light source is non-user replaceable.

## Installation instructions

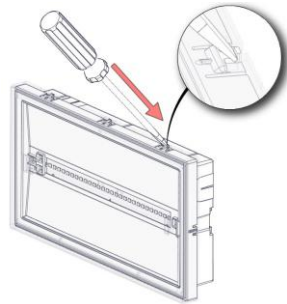

1

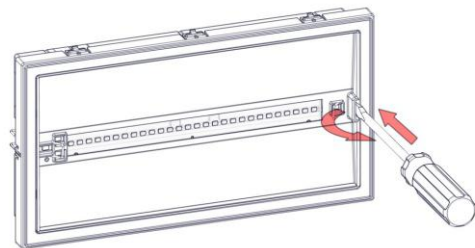

2

1

921527003\_09\_001

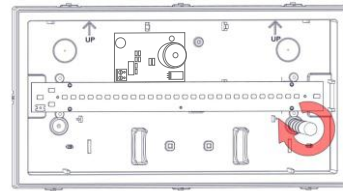

3

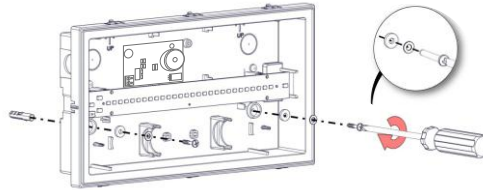

4

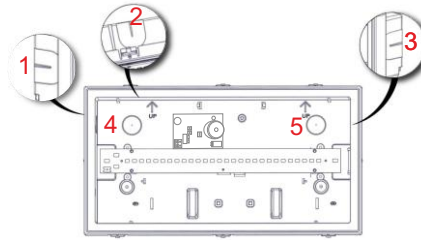

Drill one of the 5 available holes with a 16-18mm drill bit. Install the included rubber gasket and pass through the power cables.

5

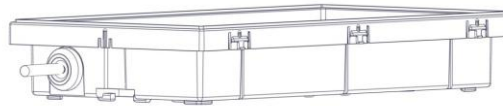

Always use in any case round mains cable, with a diameter of 5-10mm (H05RN-F type 2x1mm<sup>2</sup> or any other type, at least equal to it's mechanical and electrical properties). ATTENTION!! The cable must not be deformed in any way (This requirement is important to ensure the IP rating).

6

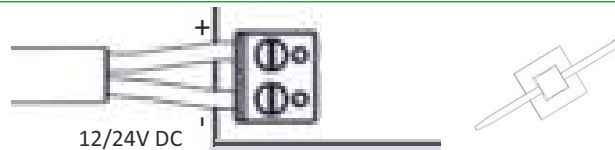

Install the included tie (if needed) to fasten securely the power cables.

7

2

921527003\_09\_001

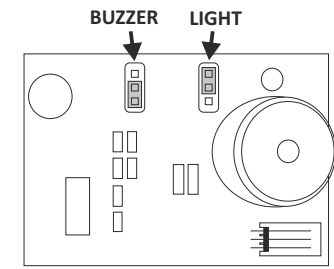

### Jumper selections

	BUZZER	LIGHT
ON	Steady sound	Permanent ON
OFF	Intermittent sound	Blink

8

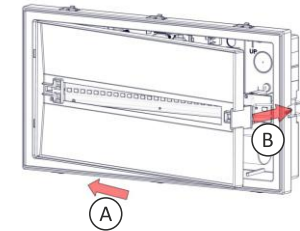

9

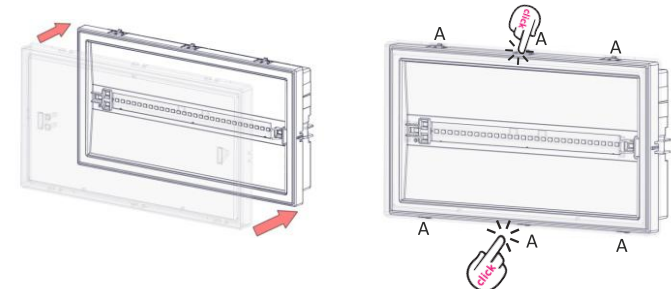

Attention!! The plastic latches (A) must be secured (click sound). This requirement is important to ensure the IP65 rating. Power on the luminary.

10

## Mounting Methods

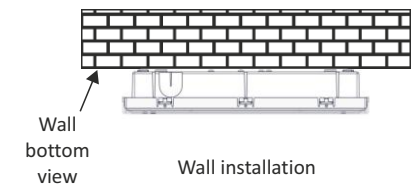

Wall bottom view

Wall installation

3

921527003\_09\_001